

NICE3000+ Integrated Solution

For elevators - serial technology



Features Highlights

- Advanced direct to floor technology
- Short floor function with distance upto 500 mm
- Built-in RTC and fault data recording

Integrated elevator solution 4.0 m/sec



Application features

- Supports PM gearless and asynchronous geared traction machines
- Smooth ride performance
- Rapid commissioning step through sequence
- Anti-rollback without any external load cell (gearless machines)
- Pre-torque function (analog signal from load cell for geared machines)
- Flexible programmable I/O's
- Static auto tuning for asynchronous and synchronous machines (without brake opening)
- Allows tuning and commissioning with single phase 220-480 Vac supply
- Standard Modbus 485 RTU allows to interface with third parties IoT
- Supports 48 floors with maximum speed of 4.0 m/s
- 8-lift grouping can possible with group control board



CAR serialiser board (MCTC-CTB-A)

Enhanced reliability with conformal coating, protects against humidity and dust pollution

Operation in high 45°C avg ambient temperature

Wide operating voltage range 323 to 528 Vac

Duplex control is a standard built-in function

Full serial connection



Mobile phone application for software updates, lift monitoring and commissioning



Wifi dongle



48 floors, full collective

Feature Highlights

- Standard: 48 floors, full collective (full serial connection)
- Duplex onboard group control (CANbus serial communication)
- Automatic door control mode
- Selectable fireman operation
- Supports 1 ph. 220 Vac UPS (quasi & sine wave) for rescue operation with intelligent light load direction search
- Comprehensive trip diagnostics
- Output frequency 0.0-99.0 Hz
- CANbus interface based door operation
- Dual fire floor function
- Supports UCM function and brake monitoring
- I/O monitoring board for MRL split panel concept
- Automatic floor detection during the shaft learning process

General connection diagram

Standard: 48 floors - full collective

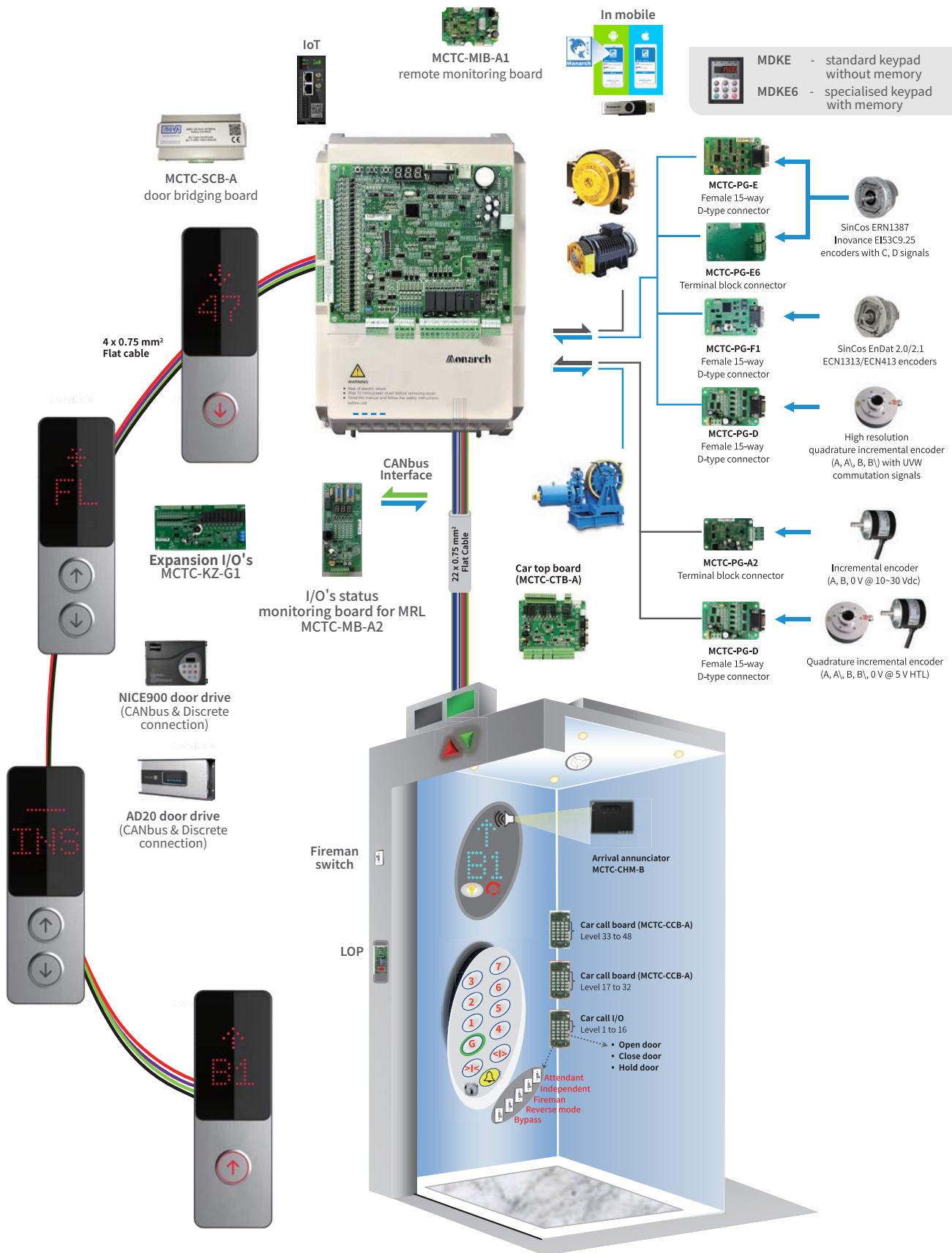

General Specifications

380 to 480 Vac, -15% to 10% (323 to 528 Vac)

Model	Frame size	Input Current [A]	Output Current [A] ^{*4}	Typical Motor [kW]	Dimensions [mm]			Dynamic Braking Unit	Dynamic Braking Resistor		
					Height [H]	Width [W]	Depth [D]		Min. [Ω]	Max. [Ω]	Recommended Power [W]
NICE-L-C-4002N-XX	C	6.5	5.1	2.2	347	223	143	Built-in	230	290	600
NICE-L-C-4003N-XX		10.5	9.0	3.7					135	170	1,100
NICE-L-C-4005N-XX		14.8	13.0	5.5					90	115	1,600
NICE-L-C-4007N-XX	D	20.5	18.0	7.5	347	223	174		65	85	2,500
NICE-L-C-4011N-XX		29.0	27.0	11.0					43	55	3,500
NICE-L-C-4015N-XX		36.0	33.0	15.0					35	43	4,500
NICE-L-C-4018N-XX	E	41.0	39.0	18.5	350	210	188		25	34	5,500
NICE-L-C-4022N-XX		49.0	48.0	22.0					22	24	6,500
NICE-L-C-4030N-XX	F	62.0	60.0	30.0	400	250	212		16	20	9,000
NICE-L-C-4037N-XX		77.0	75.0	37.0					13	16	11,000
NICE-L-C-4045N-XX		93.0	91.0	45.0				11	14	13,500	

^{*4} Carrier switching frequency 6kHz at rated output current @150% overload for 60 sec & 200% for 2 sec

Please note: - in CE countries, the recommended RFI filter must be fitted together with screened cables for EMC compliance

RFI Filter & AC Line Reactor Specifications

380 to 480 Vac, -15% to 10% (323 to 528 Vac)

Model	Frame size	Input Current [A]	Power Capacity [kVA]	Optional: External Components		Optional
				RFI Filter Model (Changzhou Jianli)	RFI Filter Model (Schaffner)	AC Input Reactor Model (Inovance)
NICE-L-C-4002N-XX	C	6.5	4	DL-10EBK5	FN3258-7-44	MD-ACL-7-3.5-4T-4%
NICE-L-C-4003N-XX		10.5	5.9	DL-16EBK5	FN3258-16-44	MD-ACL-10-2.8-4T-4%
NICE-L-C-4005N-XX		14.8	8.9			MD-ACL-15-1.9-4T-4%
NICE-L-C-4007N-XX	D	20.5	11	DL-25EBK5	FN3258-30-33	MD-ACL-20-1.4-4T-4%
NICE-L-C-4011N-XX		29.0	17	DL-35EBK5		MD-ACL-30-0.93-4T-4%
NICE-L-C-4015N-XX		36.0	21	DL-50EBK5	FN3258-42-33	MD-ACL-40-0.7-4T-4%
NICE-L-C-4018N-XX	E	41.0	24	DL-50EBK5	FN3258-42-33	MD-ACL-50-0.56-4T-4%
NICE-L-C-4022N-XX		49.0	30		FN3258-55-34	
NICE-L-C-4030N-XX	F	62.0	40	DL-65EBK5	FN3258-75-34	MD-ACL-60-0.24-4T-2%
NICE-L-C-4037N-XX		77.0	57	DL-80EBK5	FN3258-100-35	MD-ACL-90-0.16-4T-2%
NICE-L-C-4045N-XX		93.0	69	DL-100EBK5	FN3258-100-35	MD-ACL-120-0.12-4T-2%

General Specifications

220 to 240 Vac, -15% to 10% (187 to 264 Vac)

Model	Frame size	Input Current [A]		Output Current [A] ⁵		Typical Motor [kW]		Dimensions [mm]			Dynamic Braking Unit	Dynamic Braking Resistor					
		1Ø	3Ø	1Ø	3Ø	1Ø	3Ø	Height [H]	Width [W]	Depth [D]		Min. [Ω]		Max. [Ω]		Recommended Power [W]	
		1Ø	3Ø	1Ø	3Ø	1Ø	3Ø					1Ø	3Ø	1Ø	3Ø	1Ø	3Ø
NICE-L-C-2002N-XX	C	9.2	11.0	5.2	9.6	1.1	2.2	347	223	143	In-Built	125	65	145	72	300	600
NICE-L-C-2003N-XX		13.3	17.0	7.5	14.0	1.5	3.7					90	50	105	54	450	1,100
220-NICE-L-C-4007N-XX	D	17.9	20.5	10.3	18.0	2.2	4.0	347	223	173		63	35	72	40	600	1,200
220-NICE-L-C-4011N-XX		25.3	29.0	15.5	27.0	3.7	5.5					37	25	43	29	1,100	1,600
220-NICE-L-C-4015N-XX		31.3	36.0	19.0	33.0	4.0	7.5					35	22	40	26	1,200	2,500
220-NICE-L-C-4018N-XX	E	34.6	41.0	22.5	39.0	5.5	11.0	350	210	188		25	13	29	14.5	1,600	3,500
220-NICE-L-C-4022N-XX		42.6	49.0	27.7	48.0	11.0	15.0					16	12.5	18	13	3,500	4,500
220-NICE-L-C-4030N-XX	F	52.6	62.0	34.6	60.0	15.0	18.5	400	250	212		13	12	13	12.5	4,500	5,500

⁵ Carrier switching frequency 6kHz at rated output current @150% overload for 60 sec & 200% for 2 sec

Please note: - in CE countries, the recommended RFI filter must be fitted together with screened cables for EMC compliance

RFI Filter & AC Line Reactor Specifications

220 to 240 Vac, -15% to 10% (187 to 264 Vac)

Model	Frame size	Input Current [A]		Power Capacity [kVA]		Optional: External Components				Optional
		1Ø	3Ø	1Ø	3Ø	RFI Filter Model (Changzhou Jianli)		RFI Filter Model (Schaffner)		AC Input Reactor Model (Invoance)
		1Ø	3Ø	1Ø	3Ø	1Ø	3Ø	1Ø	3Ø	
NICE-L-C-2002N-XX	C	9.2	11.0	2.0	4.0	DL-16TH1	DL-16EBK5	FN3258-7-44		MD-ACL-15-4T-552-2%
NICE-L-C-2003N-XX		13.3	17.0	2.9	5.9	DL-20TH1	DL-25EBK5	FN3258-16-44		MD-ACL-30-4T-113-2%
220-NICE-L-C-4007N-XX	D	17.9	20.5	3.9	7.0	DL-25EBK5		FN3258-30-33		MD-ACL-30-4T-113-2%
220-NICE-L-C-4011N-XX		25.3	29.0	5.9	10.0	DL-35EBK5				MD-ACL-30-4T-113-2%
220-NICE-L-C-4015N-XX		31.3	36.0	7.3	12.6	DL-35EBK5	DL-50EBK5	FN3258-42-33	MD-ACL-50-4T-153-2%	
220-NICE-L-C-4018N-XX	E	34.6	41.0	8.6	15.0	DL-50EBK5		FN3258-42-33		MD-ACL-50-4T-183-2%
220-NICE-L-C-4022N-XX		42.6	49.0	10.6	18.3			FN3258-55-34		MD-ACL-50-4T-183-2%
220-NICE-L-C-4030N-XX	F	52.6	62.0	13.1	23.0	DL-65EBK5		FN3258-75-34		MD-ACL-80-4T-303-2%

Dimensions

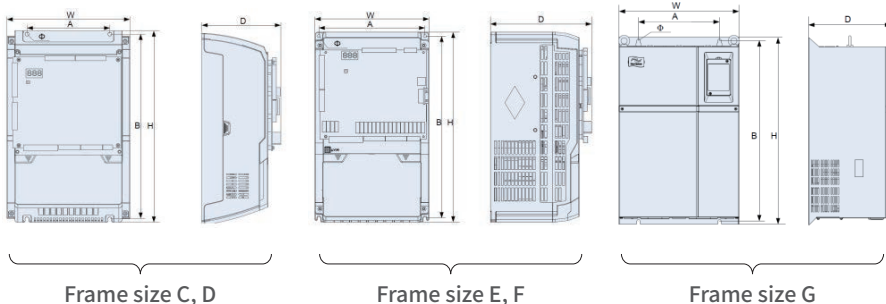

Frame size	Reference [mm]					Weight [kg]
	A	B	W	H	D	
C	150	335	223	347	143	5.5
D					174	7.0
E	195	335	210	350	188	9.1
F	230	380	250	400	212	17.0
G	245	523	385	600	268	35.0

Vertical Display Series

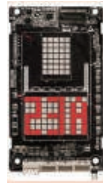

MCTC-HCB-R600 (red)
MCTC-HCB-R610 (amber)
MCTC-HCB-R630 (white)



MCTC-HCB-D634 (white)
MCTC-HCB-D614 (amber)
MCTC-HCB-D604 (red)



MCTC-HCB-D631 (white)
MCTC-HCB-D611 (amber)
MCTC-HCB-D601 (red)

Hardware configuration	High contrast dot-matrix LED display	4.3' LED segment display	6.4' LED segment display
Dimensions [L x W x D] (mm)	130 x 72 x 5.7	130 x 72 x 5.7	173 x 118 x 7.1
Function configuration			
Scrolling arrow	<input checked="" type="checkbox"/>	<input checked="" type="checkbox"/>	<input checked="" type="checkbox"/>
Scrolling characters	<input checked="" type="checkbox"/>	<input checked="" type="checkbox"/>	<input checked="" type="checkbox"/>
Hall call input/output	<input checked="" type="checkbox"/>	<input checked="" type="checkbox"/>	<input checked="" type="checkbox"/>
Fire emergency input	<input checked="" type="checkbox"/>	<input checked="" type="checkbox"/>	<input checked="" type="checkbox"/>
Elevator lock	<input checked="" type="checkbox"/>	<input checked="" type="checkbox"/>	<input checked="" type="checkbox"/>
Text display	INS, OL, FL, FIRE	INS, OL, FL, FIRE	INS, OL, FL, FIRE



MCTC-HCB-U673
(White text with blue background)
MCTC-HCB-U633
(White text with black background)



MCTC-HCB-U671
(White text with blue background)
MCTC-HCB-U631
(White text with black background)



MCTC-HCB-T640

Hardware configuration	4.3' LCD Segment display	6.4" inch LCD Segment Display	4.3" inch TFT Display Resolution: 480 x 272 pixels
Dimensions [L x W x D] (mm)	140 x 76 x 6.4	185 x 131 x 18	145 x 85 x 14
Function configuration			
Scrolling arrow			<input checked="" type="checkbox"/>
Scrolling characters			<input checked="" type="checkbox"/>
Hall call input/output	<input checked="" type="checkbox"/>		<input checked="" type="checkbox"/>
Fire emergency input	<input checked="" type="checkbox"/>		<input checked="" type="checkbox"/>
Elevator lock	<input checked="" type="checkbox"/>		<input checked="" type="checkbox"/>
Text display	Pictorial icon	Pictorial icon	<input checked="" type="checkbox"/>
Supports horizontal / vertical display	<input checked="" type="checkbox"/>	<input checked="" type="checkbox"/>	<input checked="" type="checkbox"/>



MCTC-HCB-T647



MCTC-HCB-T649



MCTC-HCB-T64A

Hardware configuration	7" inch TFT Display Resolution: 800 x 480 pixels	9.7" inch TFT Display Resolution: 1024 x 768 pixels	10.1" inch TFT Display Resolution: 1024 x 600 pixels
Dimensions [L x W x D] (mm)	188.5 x 112.2 x 19.2	225 x 240 x 25	255 x 155 x 20.2
Function configuration			
Scrolling arrow	<input checked="" type="checkbox"/>	<input checked="" type="checkbox"/>	<input checked="" type="checkbox"/>
Scrolling characters			
Hall call input/output			
Fire emergency input			
Elevator lock			
Text display	<input checked="" type="checkbox"/>	<input checked="" type="checkbox"/>	<input checked="" type="checkbox"/>
Supports horizontal / vertical display	<input checked="" type="checkbox"/>	<input checked="" type="checkbox"/>	<input checked="" type="checkbox"/>



MCTC-HCB-M618



MCTC-HCB-M61A



MCTC-HCB-M61B/C

Hardware configuration	8" inch TFT Video Display Resolution: 800 x 600 pixels	10.4" inch TFT Video Display Resolution: 1024 x 768 pixels	12.1 / 15 inch TFT Video Display Resolution: 1024 x 768 pixels
Dimensions [L x W x D] (mm)	210 x 195 x 25	256 x 239.3 x 25	290 x 260 x 27 / 355 x 315 x 27
Function configuration			
Scrolling arrow	<input checked="" type="checkbox"/>	<input checked="" type="checkbox"/>	<input checked="" type="checkbox"/>
Scrolling characters			
Hall call input/output			
Fire emergency input			
Elevator lock			
Text display	<input checked="" type="checkbox"/>	<input checked="" type="checkbox"/>	<input checked="" type="checkbox"/>
Supports horizontal / vertical display	<input checked="" type="checkbox"/>	<input checked="" type="checkbox"/>	<input checked="" type="checkbox"/>

Horizontal Display Series



MCTC-HCB-G3 (red)

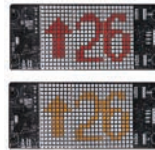

MCTC-HCB-R602 (red)
MCTC-HCB-R612 (amber)



MCTC-HCB-D632 (White)
MCTC-HCB-D612 (amber)
MCTC-HCB-D602 (Red)

Hardware configuration	7 x 15 high contrast dot-matrix LED display - 2 programmable illuminated block	16x24 high contrast dot-matrix LED display	6.4' LED segment display
Dimensions [L x W x D] (mm)	160 x 136 x 14	157 x 65 x 22	173 x 118 x 7.1
Function configuration			
Scrolling arrow	<input checked="" type="checkbox"/>	<input checked="" type="checkbox"/>	
Scrolling characters	<input checked="" type="checkbox"/>	<input checked="" type="checkbox"/>	
Hall call input/output		<input checked="" type="checkbox"/>	
Fire emergency input		<input checked="" type="checkbox"/>	
Elevator lock		<input checked="" type="checkbox"/>	
Text display	INS, OL, FL, FIRE	INS, OL, FL, FIRE	INS, OL, FL, FIRE



MCTC-HCB-U672
(white with blue background)
MCTC-HCB-U632
(white with black background)



MCTC-HCB-T647

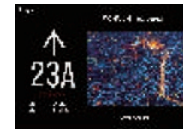

MCTC-HCB-T648

Hardware configuration	6.4 inch LCD Segment Display	7 inch TFT colour display Resolution: 800 x 480 pixels	8 inch TFT colour display Resolution: 800 x 600 pixels
Dimensions [L x W x D] (mm)	185 x 131 x 18	112.2 x 188.5 x 19.2	200 x 240 x 25
Function configuration			
Scrolling arrow		<input checked="" type="checkbox"/>	<input checked="" type="checkbox"/>
Scrolling characters			
Hall call input/output			
Fire emergency input			
Elevator lock			
Text display		<input checked="" type="checkbox"/>	<input checked="" type="checkbox"/>
Supports horizontal / vertical display	Pictorial icon	<input checked="" type="checkbox"/>	<input checked="" type="checkbox"/>



MCTC-HCB-T649



MCTC-HCB-T64A



MCTC-HCB-M618

Hardware configuration	9.7 inch TFT colour display Resolution: 1024 x 768 pixels	10.1 inch TFT colour display Resolution: 1024 x 600 pixels	8 inch TFT Video display Resolution: 800 x 600 pixels
Dimensions [L x W x D] (mm)	200 x 270 x 25	255 x 155 x 20.2	
Function configuration			
Scrolling arrow	<input checked="" type="checkbox"/>	<input checked="" type="checkbox"/>	<input checked="" type="checkbox"/>
Scrolling characters			
Hall call input/output			
Fire emergency input			
Elevator lock			
Text display	<input checked="" type="checkbox"/>	<input checked="" type="checkbox"/>	<input checked="" type="checkbox"/>
Supports horizontal / vertical display	<input checked="" type="checkbox"/>	<input checked="" type="checkbox"/>	<input checked="" type="checkbox"/>



MCTC-HCB-M61A



MCTC-HCB-M61B



MCTC-HCB-M61C

Hardware configuration	10.4 inch TFT Video display Resolution: 1024 x 768 pixels	12.1 inch TFT Video display Resolution: 1024 x 768 pixels	15 inch TFT Video display Resolution: 1024 x 768 pixels
Dimensions [L x W x D] (mm)	200 x 286 x 25	230 x 320 x 27	285 x 385 x 27
Function configuration			
Scrolling arrow	<input checked="" type="checkbox"/>	<input checked="" type="checkbox"/>	<input checked="" type="checkbox"/>
Scrolling characters			
Hall call input/output			
Fire emergency input			
Elevator lock			
Text display	<input checked="" type="checkbox"/>	<input checked="" type="checkbox"/>	<input checked="" type="checkbox"/>
Supports horizontal / vertical display	<input checked="" type="checkbox"/>	<input checked="" type="checkbox"/>	<input checked="" type="checkbox"/>



LED remote keypad
MDKE (without memory)



LED remote keypad
MDKE6 (with memory)



Extension cable for remote keypad
MDCAB (01013008)

Hardware configuration	- 5 digit high brightness LED display - hot pluggable - without memory	5 digit high brightness LED display - hot pluggable - with memory for parameter upload/download	- RJ45 (male to male) straight cable
Dimensions [L x W x D] (mm)	116 x 76 x 15	116 x 76 x 27	Length: 3 metres
Function configuration	Allows rapid commissioning and maintenance via step through sequence (e.g. speed, current, DC-bus voltage, etc.)	Allows rapid commissioning and maintenance via a step through sequence (e.g. speed, current, DC-bus voltage, etc.)	Allows user to connect LED/LCD hot pluggable remote keypad via NICE3000new main board



SinCos encoder card
MCTC-PG-E



SinCos encoder card
MCTC-PG-E6



SinCos encoder card
MCTC-PG-F1

Hardware configuration	- 5 Vdc supply - female 15-way D-type connector	- 5 Vdc supply - terminal block connector	- 5 Vdc supply - female 15-way D-type connector
Dimensions [L x W x D] (mm)	83 x 55 x 15	83 x 55 x 15	83 x 55 x 15
Function configuration	SinCos ERN1387 Inovance EI53C9.25 encoders with C, D signals	SinCos ERN1387 Inovance EI53C9.25 encoders with C, D signals	SinCos EnDat 2.0/2.1 ECN1313/ECN413 encoders



Incremental encoder card
MCTC-PG-A2

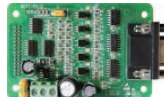

Incremental encoder card
MCTC-PG-D



Inovance SinCos encoder
EI53C9.25-2048-SA5N2T



Inovance SinCos shield cable
EP-L-P01-7.5

Hardware configuration	- 15 Vdc supply - terminal block connector	- 5 Vdc supply - female 15-way D-type connector	- rotating speed $\leq 2,000$ rpm - starting torque 1×10^2 Nm - axial load 10 N - radial load 10 N	- 2 x 7 pin 2.54 mm straight header strip female connector (encoder) - female 15-way D-type connector
Dimensions [L x W x D] (mm)	83 x 55 x 15	83 x 55 x 15	53 x 63 (length: 0.3 metres)	Length: 7.5 metres
Function configuration	Single-ended incremental encoder (A, B, Z @ 10~30 Vdc)	Quadrature incremental encoder (A, A), (B, B \), 0V @ 5 V HTL)	- supply voltage 5 Vdc ($\pm 5\%$) - Z signal amplitude ≥ 200 mV - DC offset voltage $V_d: 2.6 \text{ V} \pm 20 \text{ mV}$ - differential signal $V_{pp} 1 \text{ V} \pm 0.1 \text{ V}$ - no load current $\leq 100 \text{ mA}$ - frequency response $\leq 50 \text{ kHz}$ - resolution 2,048 PPR	Allows user to connect Inovance SinCos encoder via MCTC-PG-E



MCTC-Wifi dongle
(01270161)



Incremental encoder (A, B)
EI100H30-1024-BR30Y1



U-Type photoelectric switch
SGD31-GG-TZ2B2



Magnetic sensor
MCTC-LDB-A (1306003)

Hardware configuration	- 5 V USB	- rotating speed $\leq 5,000$ rpm - starting torque 5×10^2 Nm - axial load 10 N - radial load 10 N - $\varnothing 100$ mm	-- reverse polarity protection - detecting distance 31 m - NPN/PNP output	- detecting distance 15~30 mm
Dimensions [L x W x D] (mm)	60 x 18 x 10	173 x 47 (length: 7.5 metres)	72 x 52 x 20 (length: 2 metres)	$\varnothing 24 \times 87$ mm (length: 1 metre)
Function configuration	Allows rapid commissioning and maintenance via step through sequence smartphone Apps	- supply voltage 10~30 Vdc - signal $V_{oh} \geq 85\% V_{cc}$, $V_{ol} \leq 0.5 \text{ V}$ - push-pull current $\leq 80 \text{ mA/ch}$ - frequency response $\leq 200 \text{ kHz}$ - resolution 50~8,192 PPR	- supply voltage 12~30 Vdc - frequency response $\leq 1 \text{ kHz}$ - current consumption $\leq 60 \text{ mA}$ - output current $\leq 80 \text{ mA}$	- supply voltage 20~27 Vdc - output 0~10 Vdc

Accessories



Group control board
MCTC-GCB-B2



Car top board (horizontal connector)
MCTC-CTB-A



I/O's status monitoring board for MRL
MCTC-MB-A2



Remote monitoring board
MCTC-MIB-A1

Hardware configuration	- 1 group of RS485 - 6 groups of CAN communication ports	- 8 digital inputs - 9 relay outputs - 1 analogue (0~10 Vdc) - 1 RS485 - 1 CANbus - 2 parallel interface expansion ports	- CAN bus - RS232 - USB	- 1 RS485 - 1 RS232
Dimensions [L x W x D] (mm)	162 x 125 x 15	162 x 125 x 15	165 x 67	104 x 72 x 15
Function configuration	- minimum wait time - fuzzy logic control - password protection - group control home landing setting - peak group service - for coordination of 3~6 elevators	- double door single action operation - double door simultaneous operation - door nudging - ventilation fan control - lighting control	- X1 ~ X31 Status LED's - Y1 ~ Y9 Status LED's - MOD1 & MOD2 Status LED's - CAN1 & CAN2 Status LED's	Convert NICE3000new RS232 protocol to RS485 (RTU) for remote devices



Car call board
MCTC-CCB-A



Car call board
MCTC-CCB-B



Connection cable
MCTC-CCL-0030



Modbus decoder gateway
MCTC-KZ-A0-S

Hardware configuration	- 24 digital inputs - 20 digital outputs	- 39 digital inputs - 35 digital outputs	- DB9 (Male to Male) straight cable	- 1 RS485 input - 1 RS485 output
Dimensions [L x W x D] (mm)	79 x 158 x 16	125 x 160 x 16	Length: 3 metres	104 x 72 x 18
Function configuration	- 16 floor buttons - 8 functional signals e.g. OPEN/CLOSE, door hold, non-stop mode, attendant mode, reverse mode, independent mode, fireman mode, arrival chime	- 31 floor buttons - 8 functional signals e.g. OPEN/CLOSE, door hold, non-stop mode, attendant mode, reverse mode, independent mode, fireman mode, arrival chime	Allows user to connect the MCTC-CCB-A/B via MCTC-CTB-A/B	RS485 encode and decode gateway via NICE3000 ^{new} main board



Door bridging board
MCTC-SCB-A1 Ver.:B00



Expansion I/O's
MCTC-KZ-G1 Ver.:00



Non-display floor call board
MCTC-HCB-B



Arrival annunciator (synthesized voice)
MCTC-CHM-B

Hardware configuration	4 force guided relays	- 10 digital inputs - 10 digital outputs	- no dot-matrix display - 4 digital inputs/outputs	- bilingual voice - SD card slot
Dimensions [L x W x D] (mm)	114 x 72 x 28	178 x 88 x 15	70 x 84 x 20	114 x 89 x 39
Function configuration	Facilitates bridging the door safety circuit during re-leveling of the elevator and/or door opening, including detection of unintended movement of the car (UCM)	The expansion board has one 485 interface and one CAN bus communication interface	- travel UP & DOWN button indicator outputs - overload indicator - double button control - hall call button input - fire emergency input - lock input	Offers pre-set standard messages and allows bespoke passenger announcements via a voice synthesizer

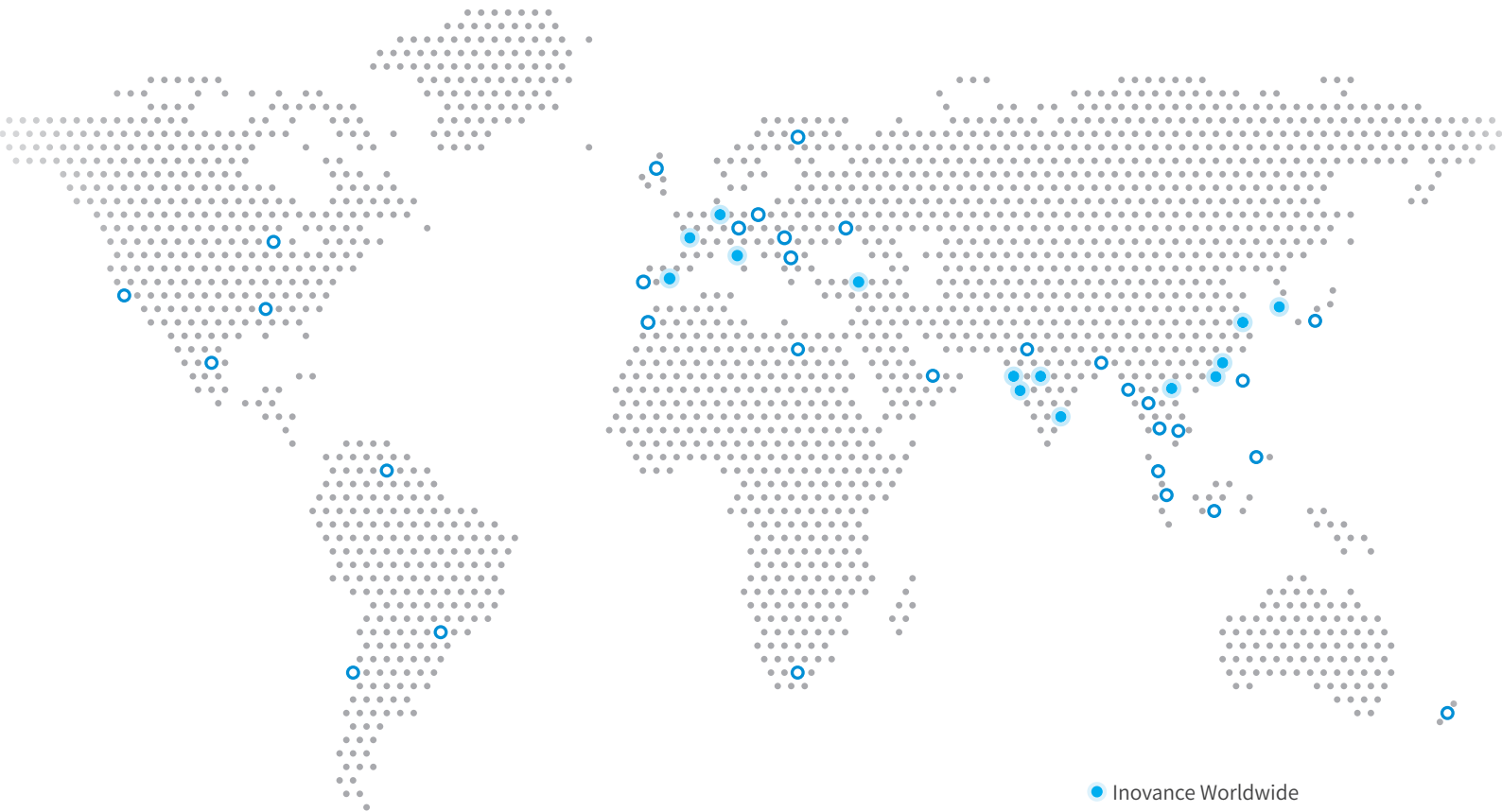

- Inovance Worldwide
- Distribution & Service Partners

Advancing industrial technology, for a better world

www.inovance.eu
Enquires: info@inovance.ind.in

**Shenzhen Inovance Technology Co., Ltd.
Suzhou Inovance Technology Co. Ltd.**

☎ 4000-300124
✉ info@inovance.com
👤 service@inovance.com

**Hong Kong SAR
International Export Office**

☎ +852 2751 6080
✉ info@inovance.eu

Germany-Stuttgart

☎ +49 (0) 7144 8990
✉ sales.de@inovance.eu

France-Bordeaux

☎ +33 (0) 5594 01050
✉ sales.fr@inovance.eu

Spain-Barcelona

☎ +34 93 504 94 48
✉ sales.es@inovance.eu

Italy-Milano

☎ +39 (0) 2268 22318
✉ sales.it@inovance.eu

Turkey-Istanbul

☎ +90 (216) 466 7600
✉ sales.tr@inovance.eu

South Korea-Seoul

☎ +82 (0) 10 7428 5732
✉ sales.kr@inovance.eu

India

☎ Head Office Chennai | +91 (0) 44 4380 0201
Ahmedabad | +91 (0) 79 40034274
Mumbai | +91 (0) 22 4516 6255
Noida | +91 (0) 120 402 8235
Hyderabad | +91 (0) 40 4951 6431
Surat | +91 93846 65692

Sales Network

Kolkata, Bengaluru, Pune, Coimbatore, Visakhapatnam, Vadodara, Jaipur

✉ info@inovance.ind.in

FOLLOW US

